



Picture is a representation of actual product.

**Approvals**



**Order Information**

Load Rating	Part #	Est. Weight	Price
150 kg	<b>41176</b>	2lb	Consult

**Dimensions**

Rated Capacity	A	B	C	D	E	F	G	H
kg/mm								
150	101.6	75.0	M10	13.0	41.0	49.5	57.2	31.8

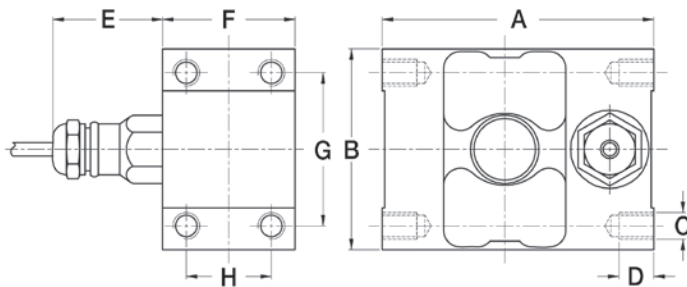

**Specifications**

**Full Scale Output:**  
2.0 mV/V

**Output Resistance:**  
960 (± 50) ohm

**Input Resistance:**  
1,100 (± 50) ohm

**Material/Finish:**  
Stainless steel

**Temperature:**  
Operating range  
0 °F to 150 °F (-18 °C to 65 °C)

**Seal Type:**  
Hermetically sealed, IP68

**Safe Overload:**  
200% full scale

**Safe Sideload:**  
100% full scale

**Rated Excitation:**  
5 to 10 VDC (15 V maximum)

**Insulation Resistance:**  
5,000 megohm

**Combined Error:**  
0.02% full scale

**Cable Length:**  
10 ft

**Cable Diameter:**  
0.196 in  
Polyurethane jacket

**Cable Color Code:**  
Green +Excitation  
Black -Excitation  
White +Signal  
Red -Signal  
Blue +Sense  
Brown -Sense  
Yellow Shield

**Warranty:**  
One-year limited

**Approvals:**  
FM