

DOUBLE-ENDED BEAM  
**RL72019SS**

Stainless Steel, Welded Seal, NTEP Certified 1:5,000 Class III/1:10,000 Class III L Multiple Cell, IP68

LOAD CELLS /  
 WEIGH MODULES



Picture is a representation of actual product.

Approvals



Order Information

Load Rating	Part #	Est. Weight	Price
5,000 lb	194021	5 lb	Consult
10,000 lb	194022	5 lb	Consult
20,000 lb	194023	5 lb	Consult
30,000 lb	194024	20 lb	Consult
40,000 lb	194025	20 lb	Consult
50,000 lb	194026	20 lb	Consult
60,000 lb	194027	20 lb	Consult

Dimensions

Rated Capacity	A	B	C	D	E	F	ØG	H
lb/in								
5,000 to 20,000	8.12	1.14	6.88	1.44	1.71	1.71	1.00	1/4-18 NPT
30,000 to 60,000	10.25	2.38	8.50	1.88	3.03	3.03	2.00	1/2-14 NPT

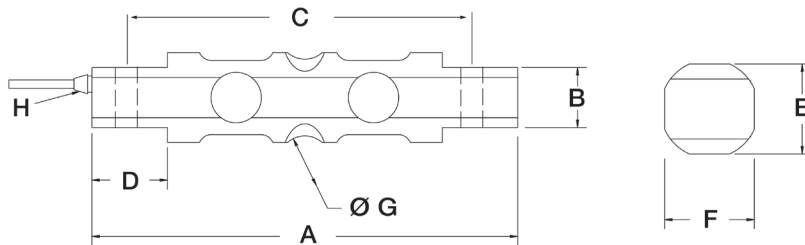

Interchangeable Products

RICE LAKE WEIGHING SYSTEMS  
**RL70000SS**  
 VPG® REVERSE  
**9103**

Weigh Module Available

RICE LAKE WEIGHING SYSTEMS  
**EZ Mount 1 SS**

Specifications

- Full Scale Output:**  
3.0 mV/V
- Output Resistance:**  
700 (± 5) ohm
- Input Resistance:**  
780 (± 10) ohm
- Material/Finish:**  
Stainless steel
- Temperature:**  
Operating range  
0 °F to 150 °F (-18 °C to 65 °C)
- Seal Type:**  
Welded-seal, IP68
- Safe Overload:**  
150% full scale
- Rated Excitation:**  
5 to 10 VDC
- Nonlinearity:**  
0.03% full scale
- Hysteresis:**  
0.5% full scale
- Insulation Resistance:**  
5,000 megohm
- Cable Length:**  
25 ft
- Cable Color Code:**  
Red +Excitation  
Black -Excitation  
Green +Signal  
White -Signal
- Warranty:**  
Two-year limited
- Approvals:**  
cFMus  
NTEP 21-064