



Picture is a representation of actual product.

**Approvals**



**Order Information**

Load Rating	Part #	Est. Weight	Price
250 lb	21402	2 lb	Consult
500 lb	21403	2 lb	Consult
750 lb	21404	2 lb	Consult
1,000 lb	21405	2 lb	Consult
1,500 lb	21406	2 lb	Consult
2,000 lb	21407	3 lb	Consult
2,500 lb	21408	4 lb	Consult
3,000 lb	21409	3 lb	Consult
5,000 lb	21410	4 lb	Consult
10,000 lb	21411	5 lb	Consult
15,000 lb	21412	7 lb	Consult
20,000 lb	21413	16 lb	Consult
<b>Conduit Adapter Kit* (must be factory installed to maintain warranty)</b>			
3/8-24 nipple	31533*	1 lb	Consult
3/8-24 to 1/4-18 NPT	31534*	1 lb	Consult

\*PN 31533 and PN 31534 must be installed together to form the Conduit Adapter Kit

**Dimensions**

Rated Capacity	A	B	C	D	E
lb/in					
250	3/8-24 UNF	0.75	0.50	2.00	3.00
500 to 2,000	1/2-20 UNF	1.00	0.75	2.00	3.00
2,500 to 3,000	1/2-20 UNF	1.25	1.00	2.00	3.00
5,000	3/4-16 UNF	1.25	1.00	3.00	4.25
10,000	3/4-16 UNF	1.25	1.00	3.50	4.75
15,000	1-14 UNS	1.50	1.25	4.00	5.50
20,000	1 1/4-12 UNF	2.25	2.00	5.00	7.00

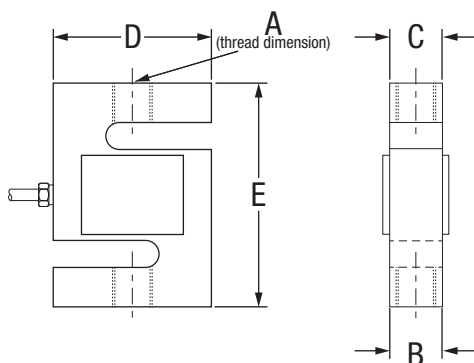

**Interchangeable Products**

- VPG® CELTRON  
**STC**.....page 188
- VPG® SENSORTRONICS®  
**60001**.....page 275

**Weigh Module Available**

- RICE LAKE WEIGHING SYSTEMS  
**ITCM Isolated Tension Cell Mount**..... page 28

**Specifications**

- Full Scale Output:**  
3.0 mV/V
- Output Resistance:**  
350 (± 3) ohm
- Input Resistance:**  
385 (± 5) ohm
- Material/Finish:**  
High-alloy steel, nickel plated
- Temperature:**  
Compensated range  
14 °F to 104 °F (-10 °C to 40 °C)  
Operating range  
0 °F to 150 °F (-18 °C to 65 °C)
- Seal Type:**  
Environmentally sealed, IP67
- Safe Overload:**  
150% full scale
- Rated Excitation:**  
5 to 10 VAC/DC (15 V maximum)
- Combined Error:**  
0.02% full scale
- Insulation Resistance:**  
5,000 megohm
- Cable Length:**  
20 ft
- Cable Diameter:**  
0.200 in polyurethane jacket
- Cable Color Code:**  
Red +Excitation  
Black -Excitation  
Green +Signal  
White -Signal
- Warranty:**  
Two-year limited
- Approvals:**  
cFMus  
NTEP 91-046

**RICE LAKE  
LOAD CELLS**